

ISTRUZIONI DI MONTAGGIO
INSTALLATION INSTRUCTIONS

INFORMAZIONI TECNICHE TECHNICAL INFORMATION



MIN 0.5 BAR
MAX 5 BAR
BEST 3 BAR



MAX 70°C
BEST 38°C



HOT/COLD water pressure
difference 1 BAR



In caso di pressione dell'acqua superiore a 5 bar, si consiglia di installare riduttori di pressione
In case of water pressure higher than 5 bar we recommend installing pressure reducers

BEFORE STARTING PRIMA DI INIZIARE

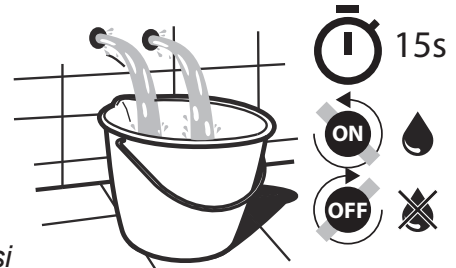

Blocco di sicurezza a **38°C**
Temperatura minima: **3°C**
Temperatura minima consigliata: **15°C**
Temperatura massima: **70°C**
Temperatura massima consigliata: **65°C**
Differenziale termico consigliato: **50°C**

Sistema di sicurezza con fermo del flusso in caso di mancanza di uno dei due flussi d'acqua

Funzionamento:
Sia con scaldabagni a gas che elettrici ad accumulo.
Impianti centralizzati.
Caldaie murali.

Attenzione: consultare il proprio idraulico di fiducia per la scelta del dispositivo di riscaldamento più idoneo.

Safety lock at **38°C**
Minimum working temperature: **3°C**
Minimum recommended: **15°C**
Maximum working temperature: **70°C**
Maximum recommended: **65°C**
Recommended thermal differential: **50°C**

Safety system with flow stop in case of loss of one of the two water supplies

Operation:
Either with gas or electric accumulation boilers.
Centralized systems.
Wall-mounted boilers.

Attention: consult your plumber to choose the most suitable heating device.

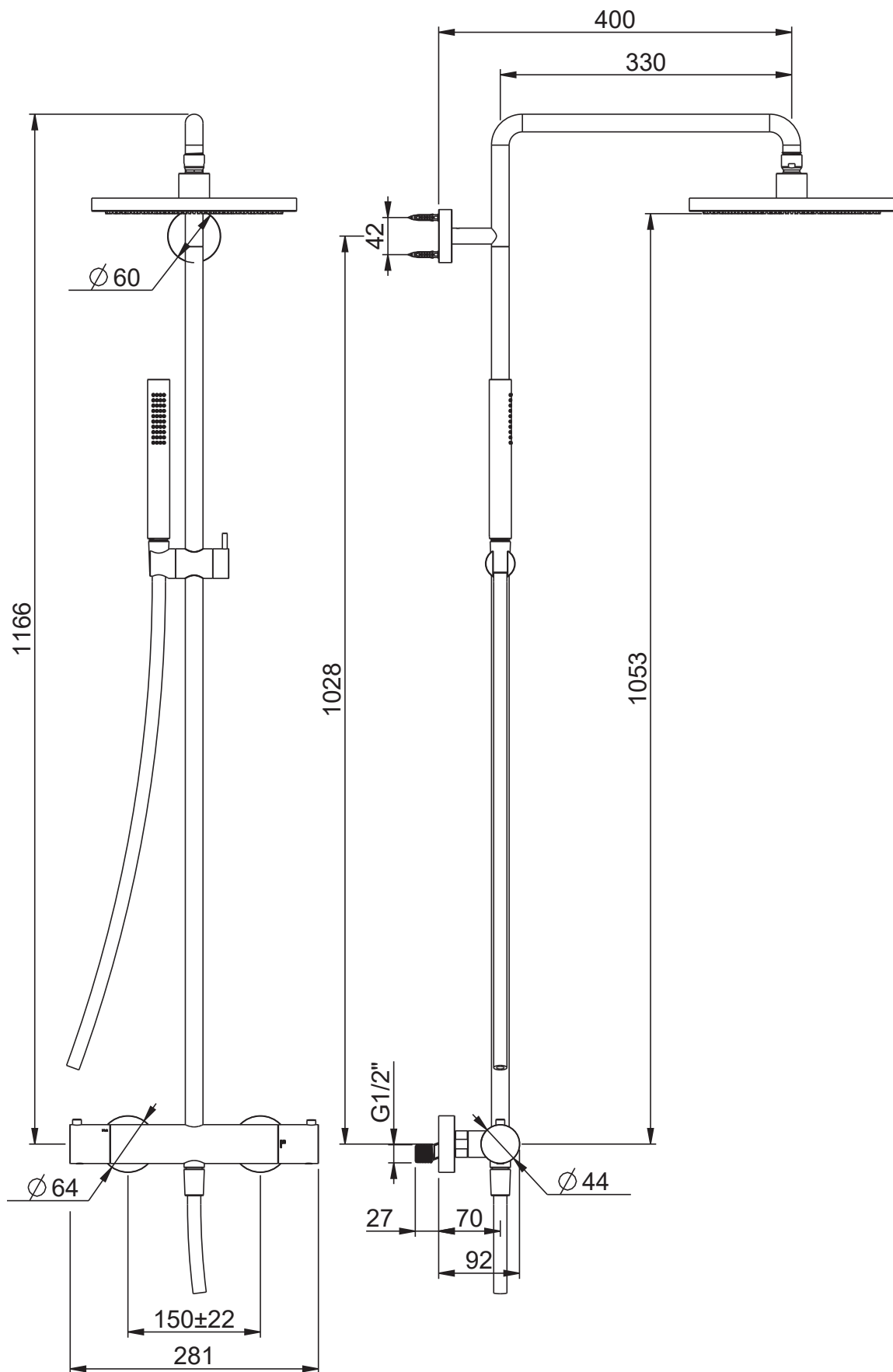

CONTENUTO CONFEZIONE

PACKAGE CONTENTS

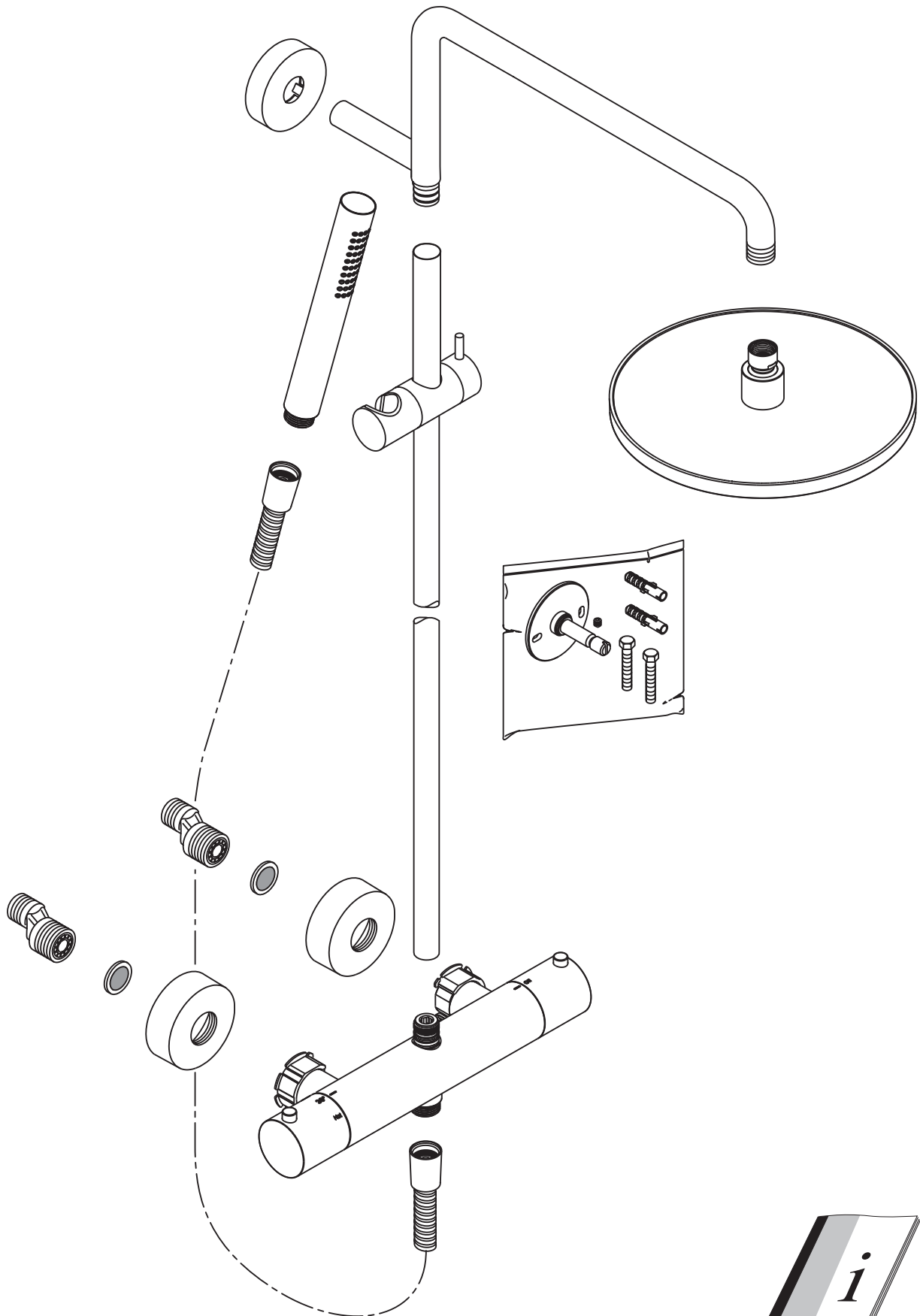

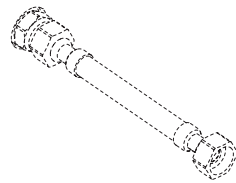
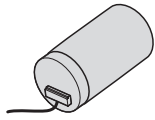
STRUMENTI NECESSARI
REQUIRED TOOLS

G 1/2"

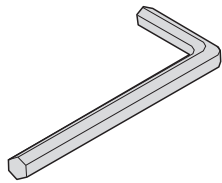
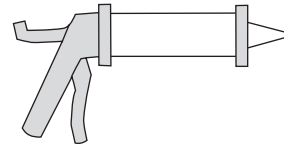

2 / 2.5 / 3 mm

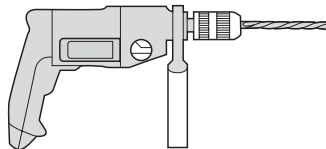
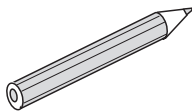
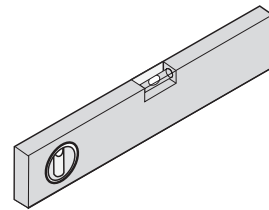

6 mm

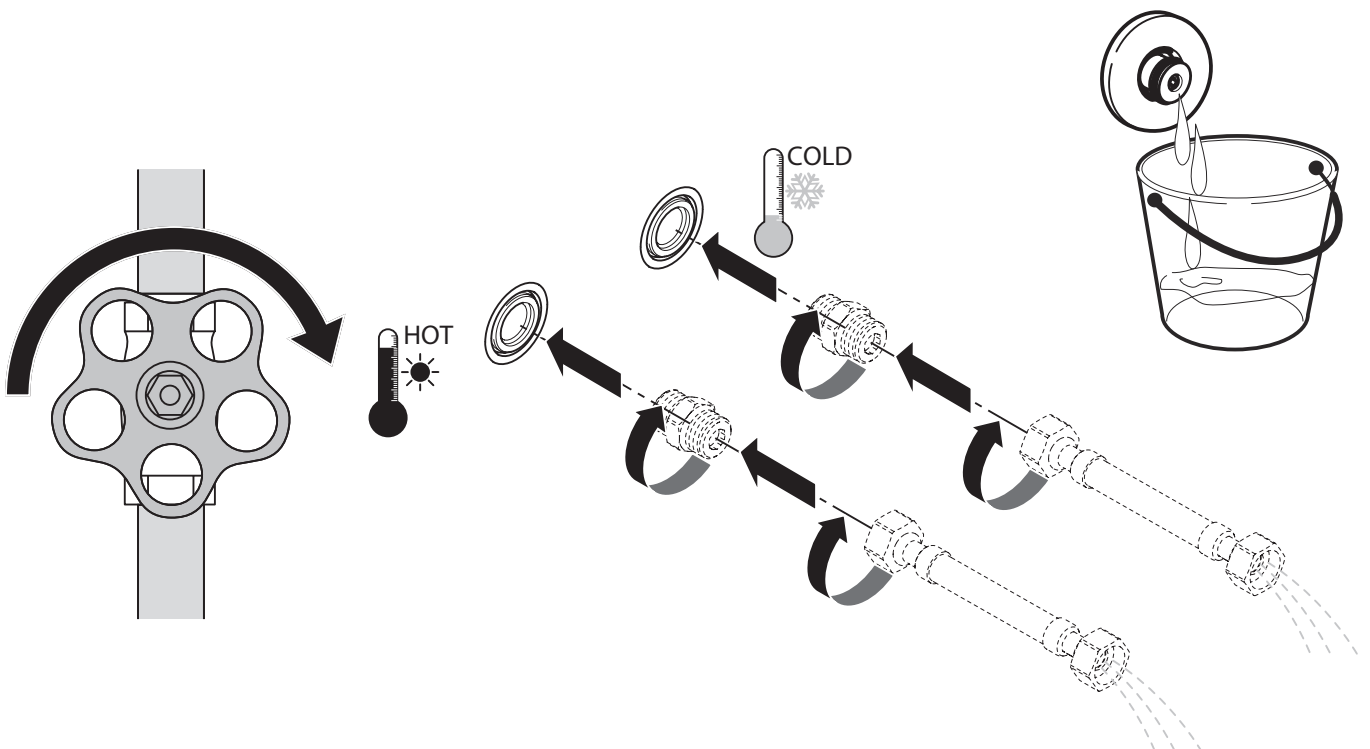
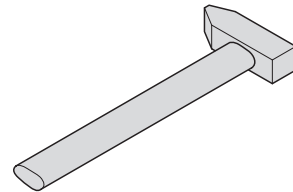

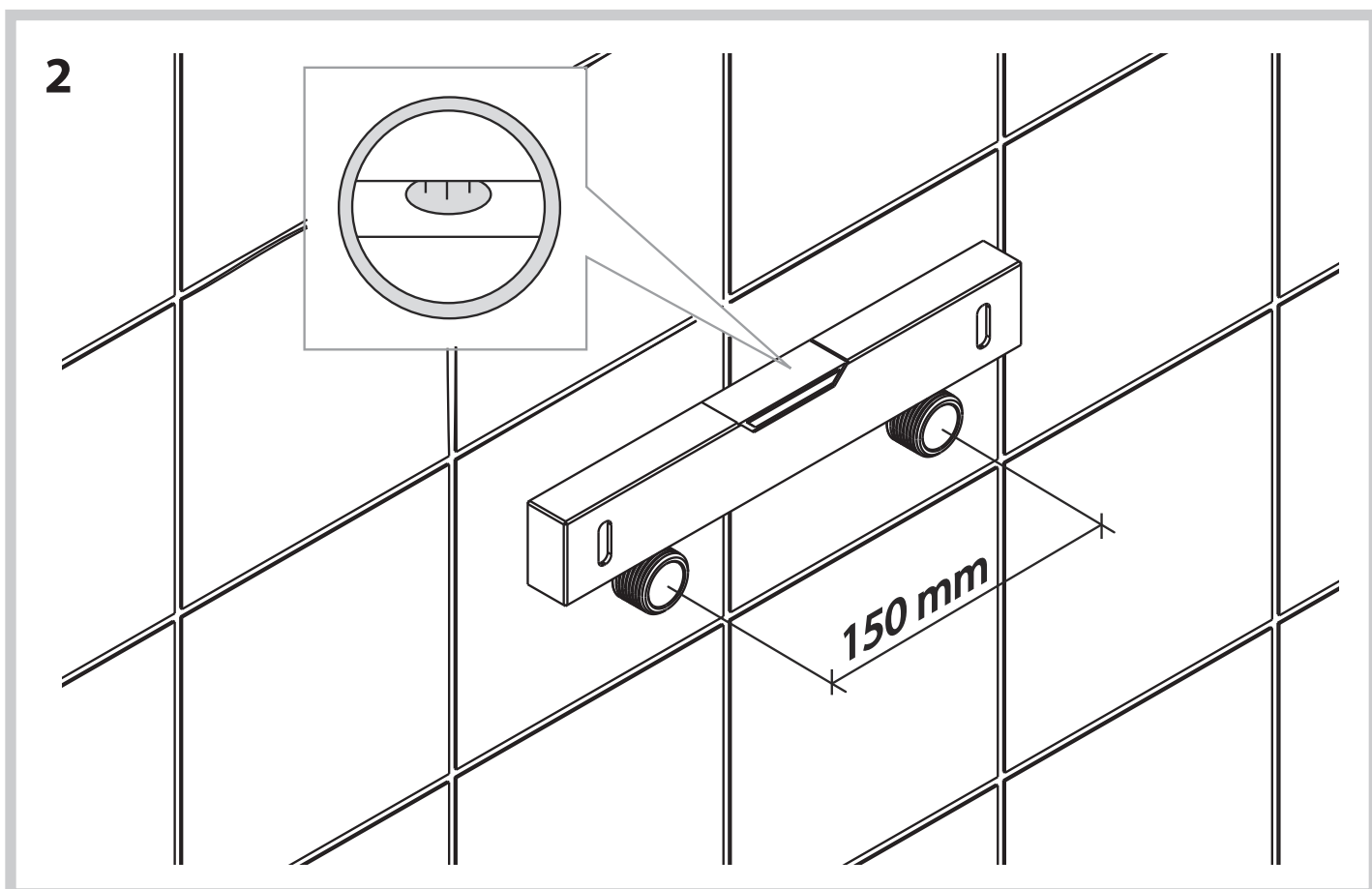
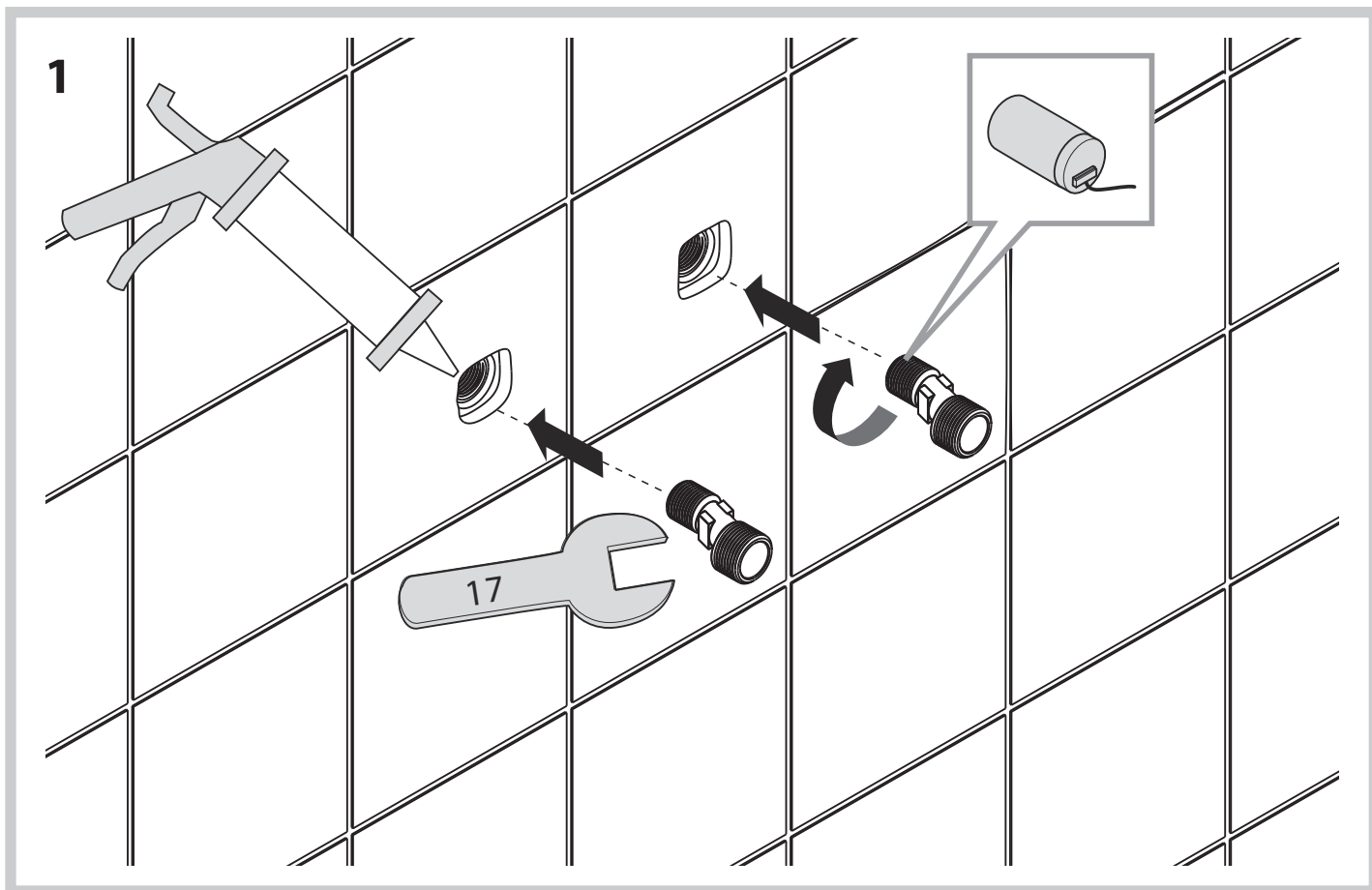

3

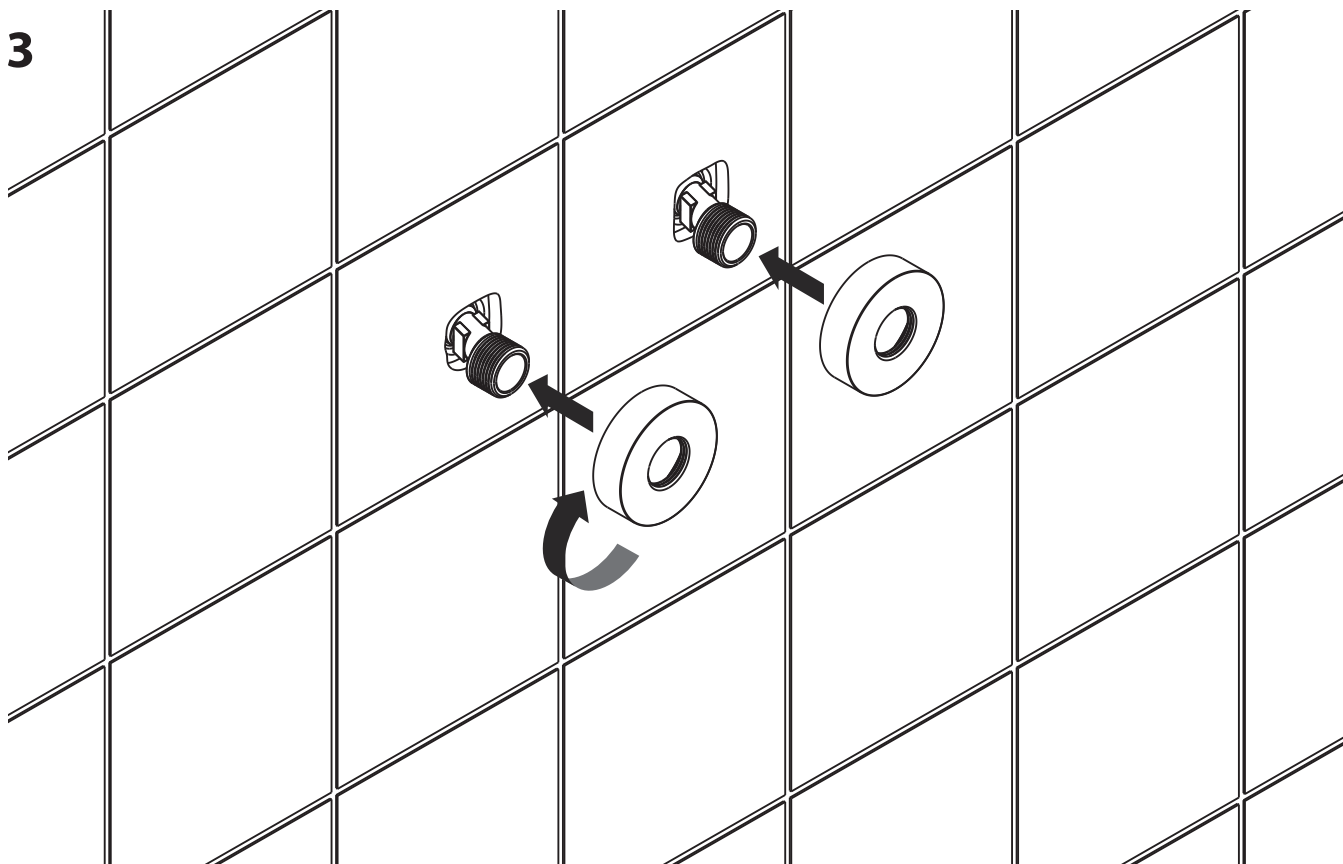

4

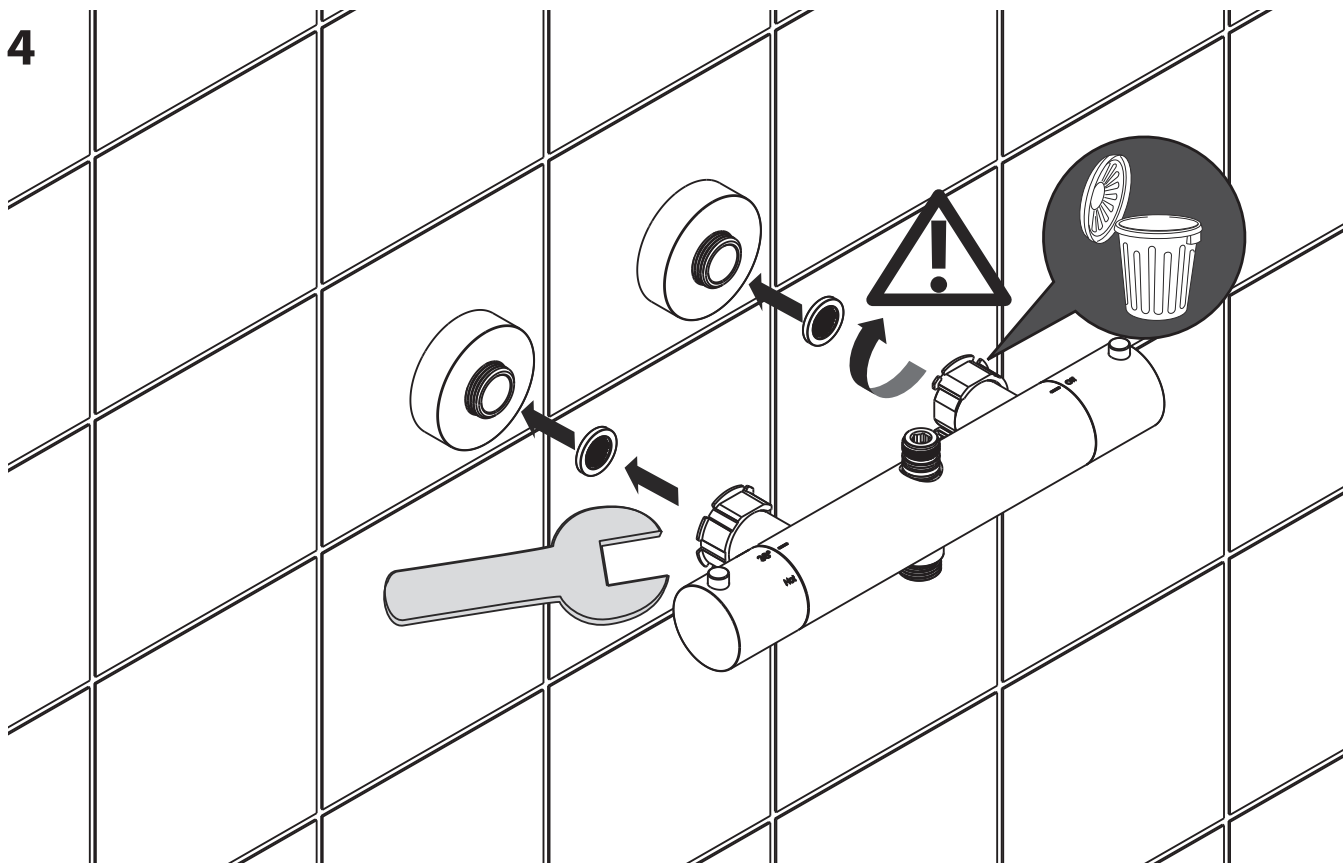

5

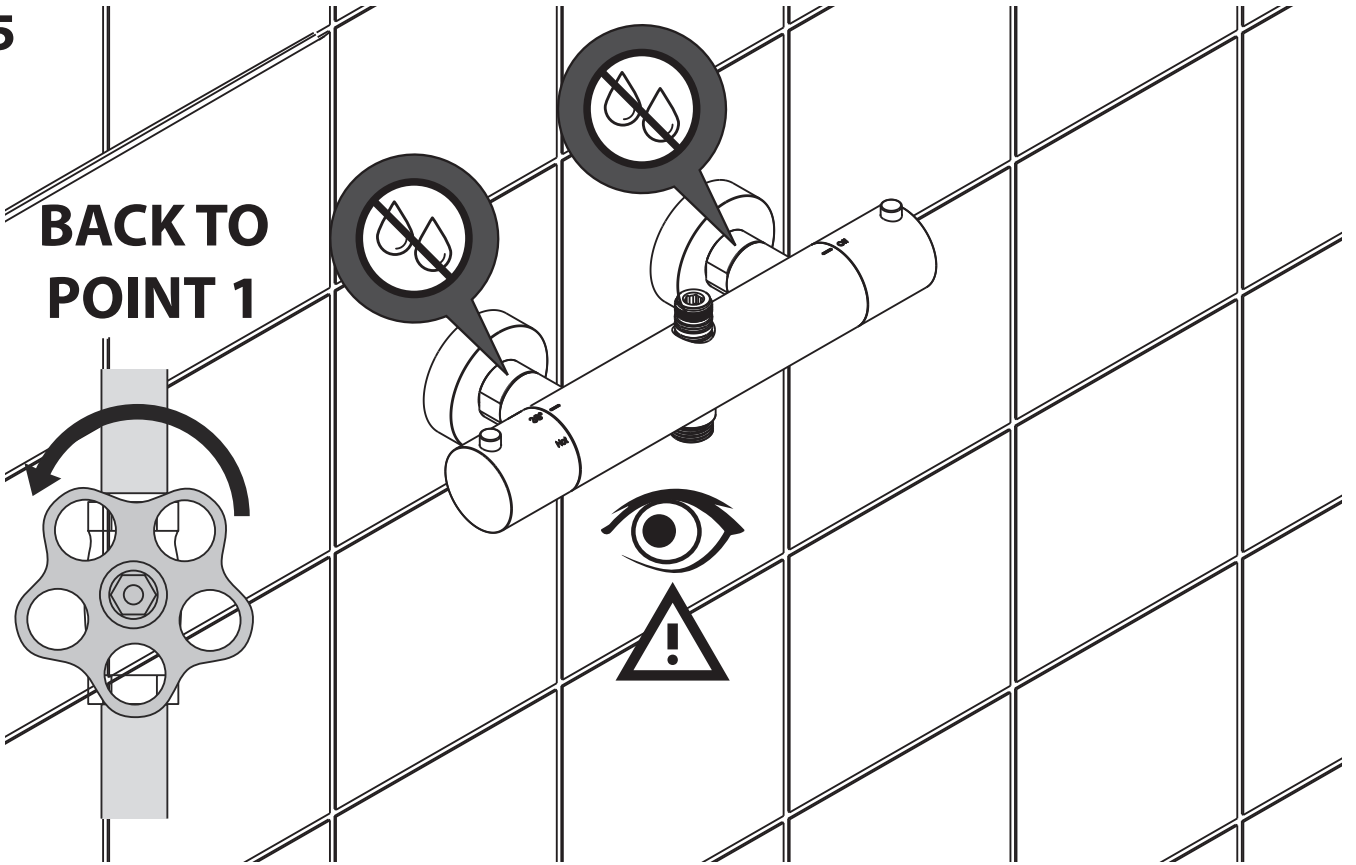
**BACK TO
POINT 1**

6

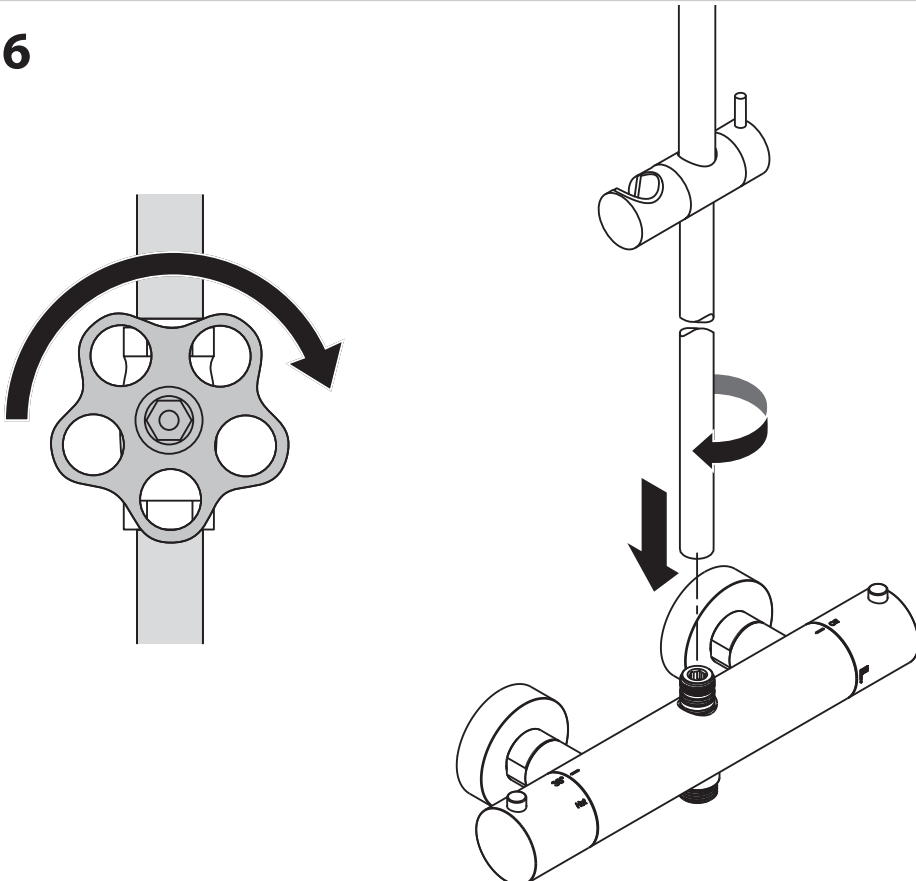

7

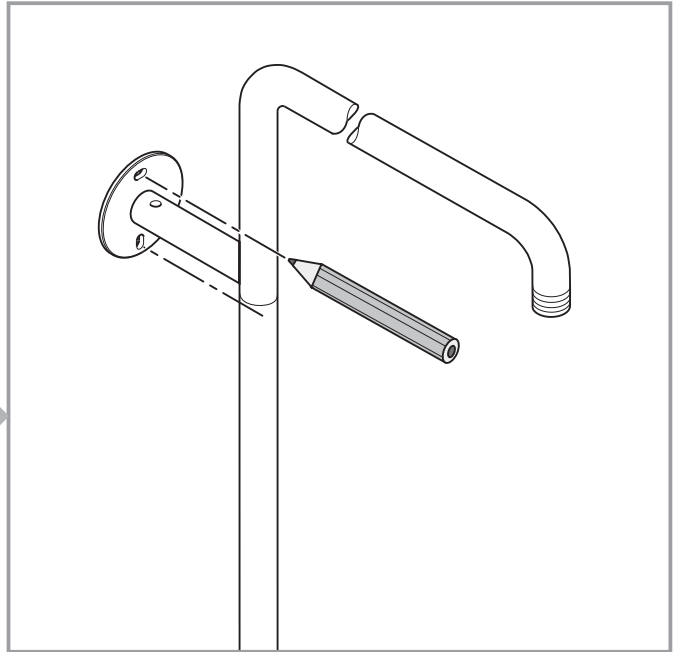
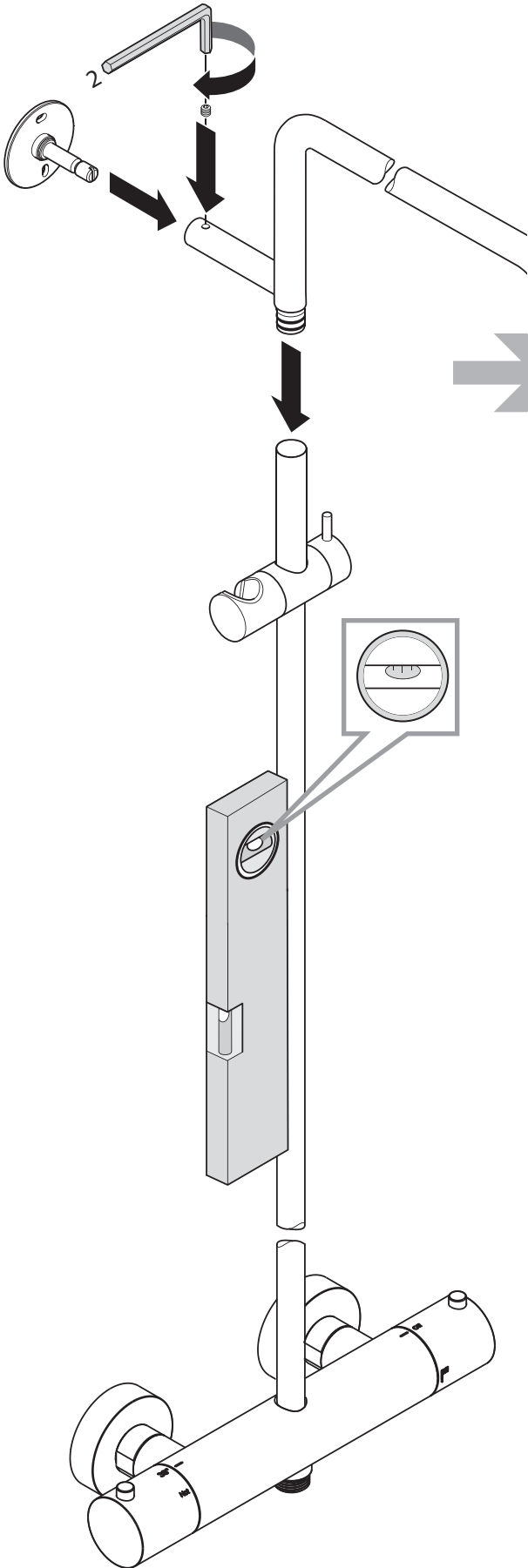

8

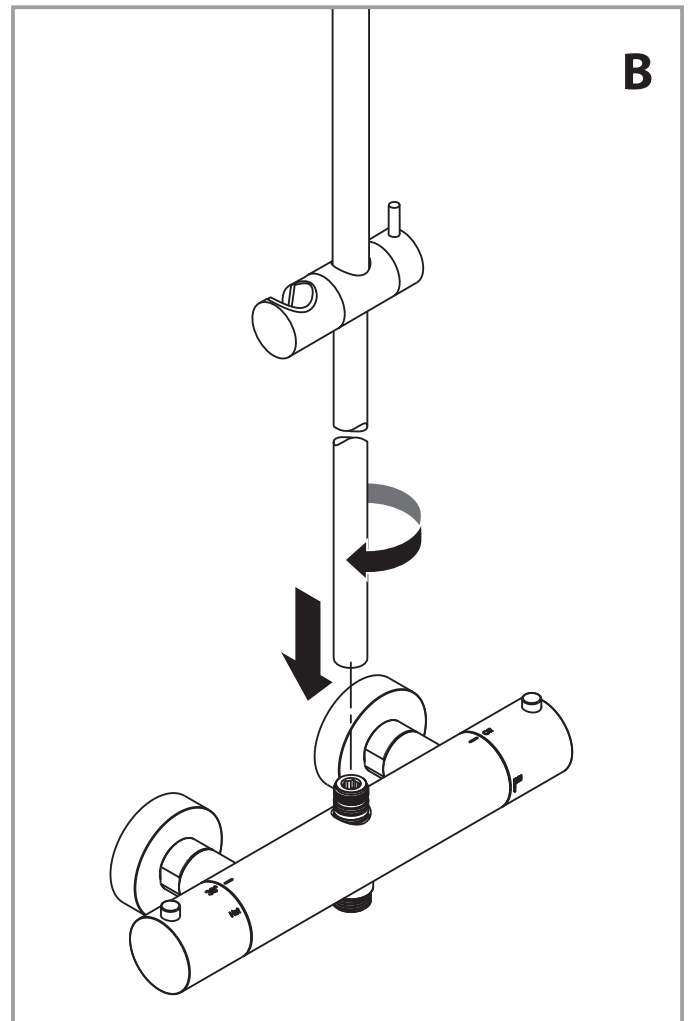
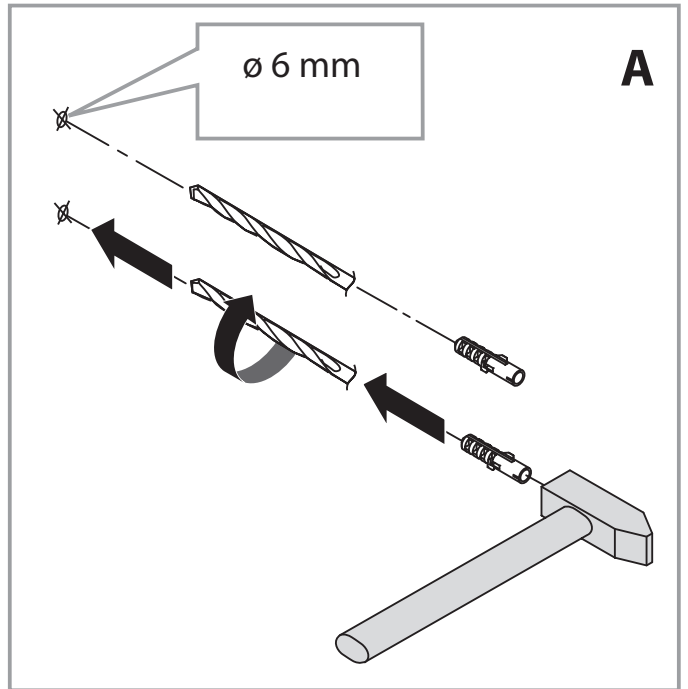
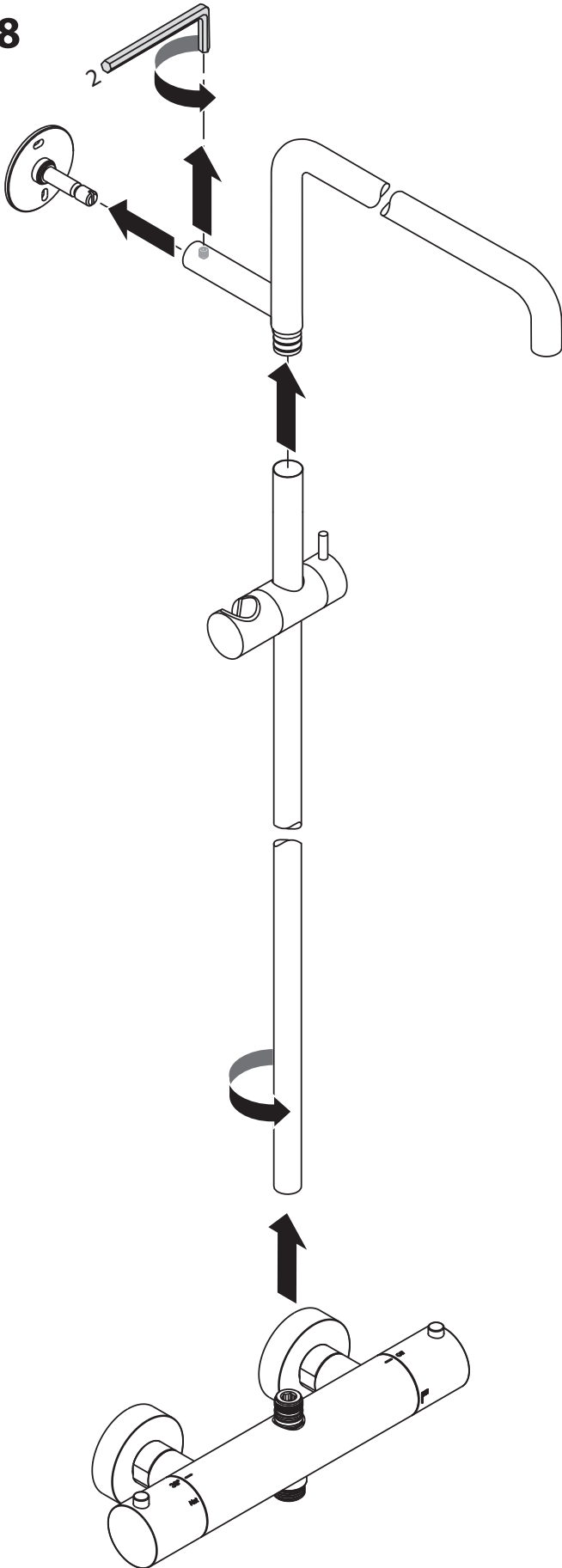

9

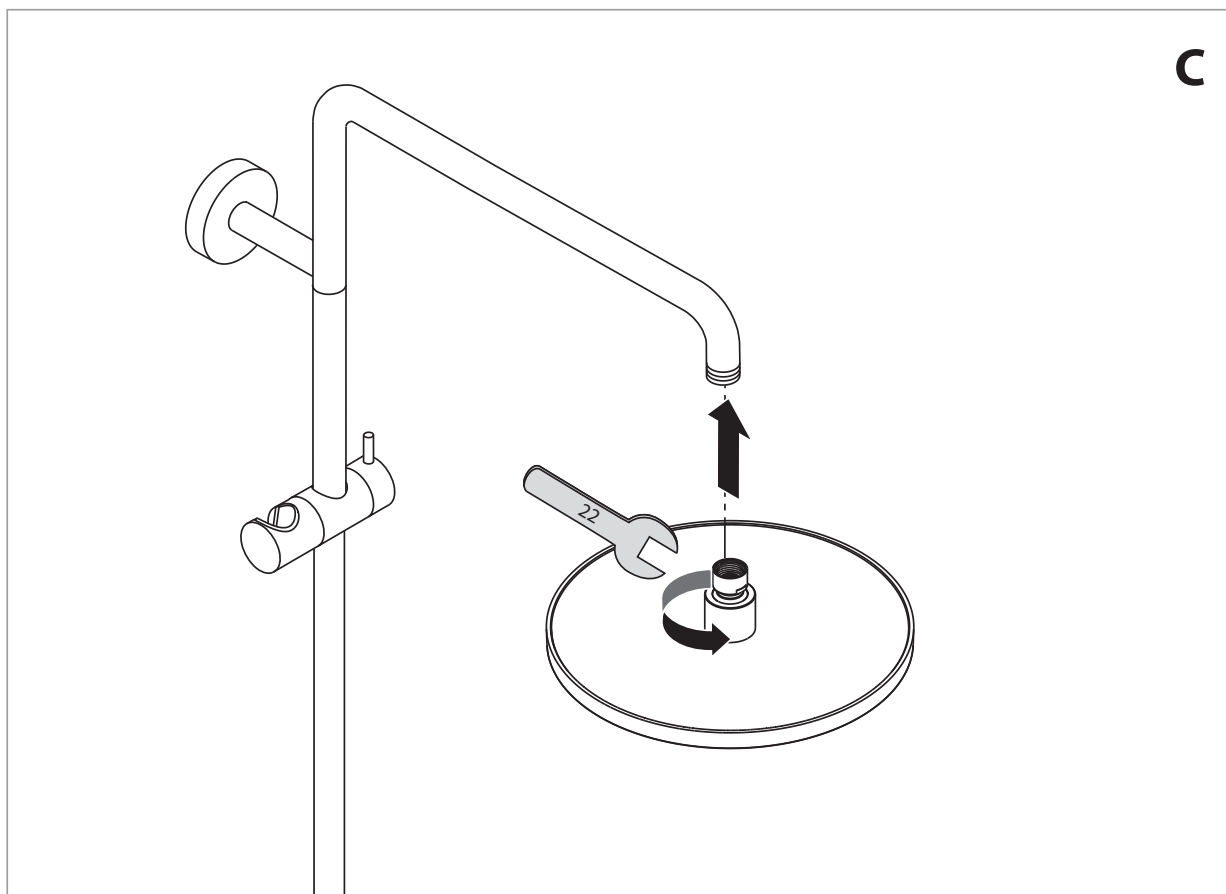
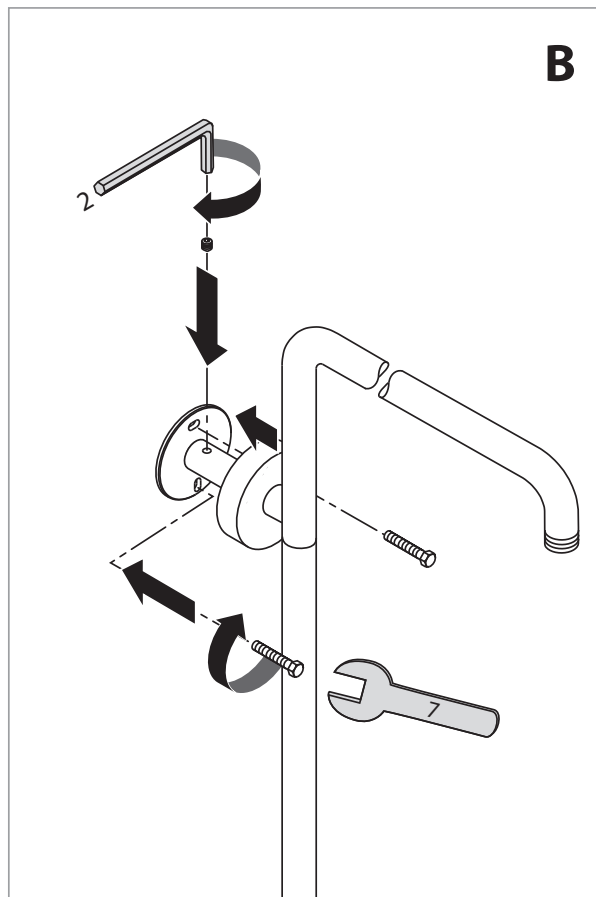
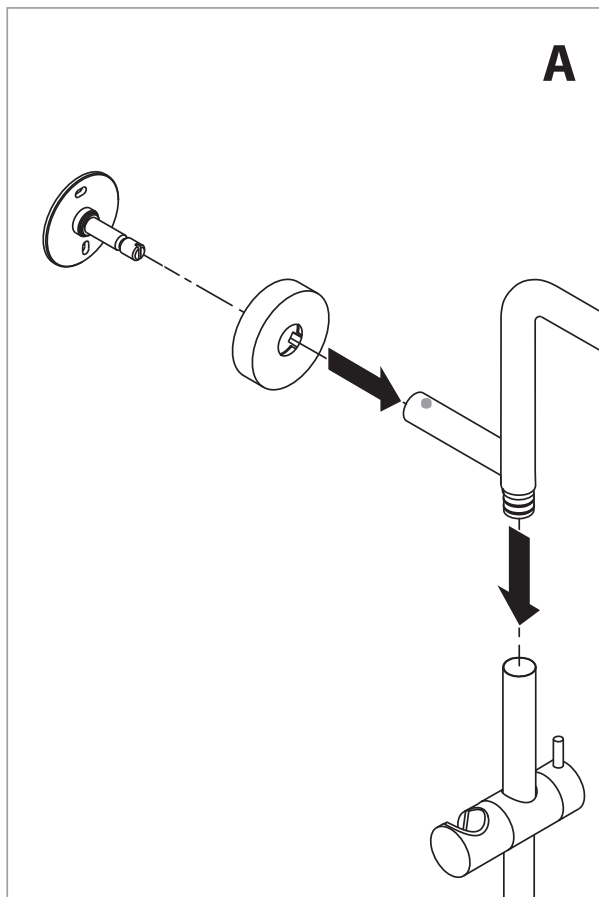

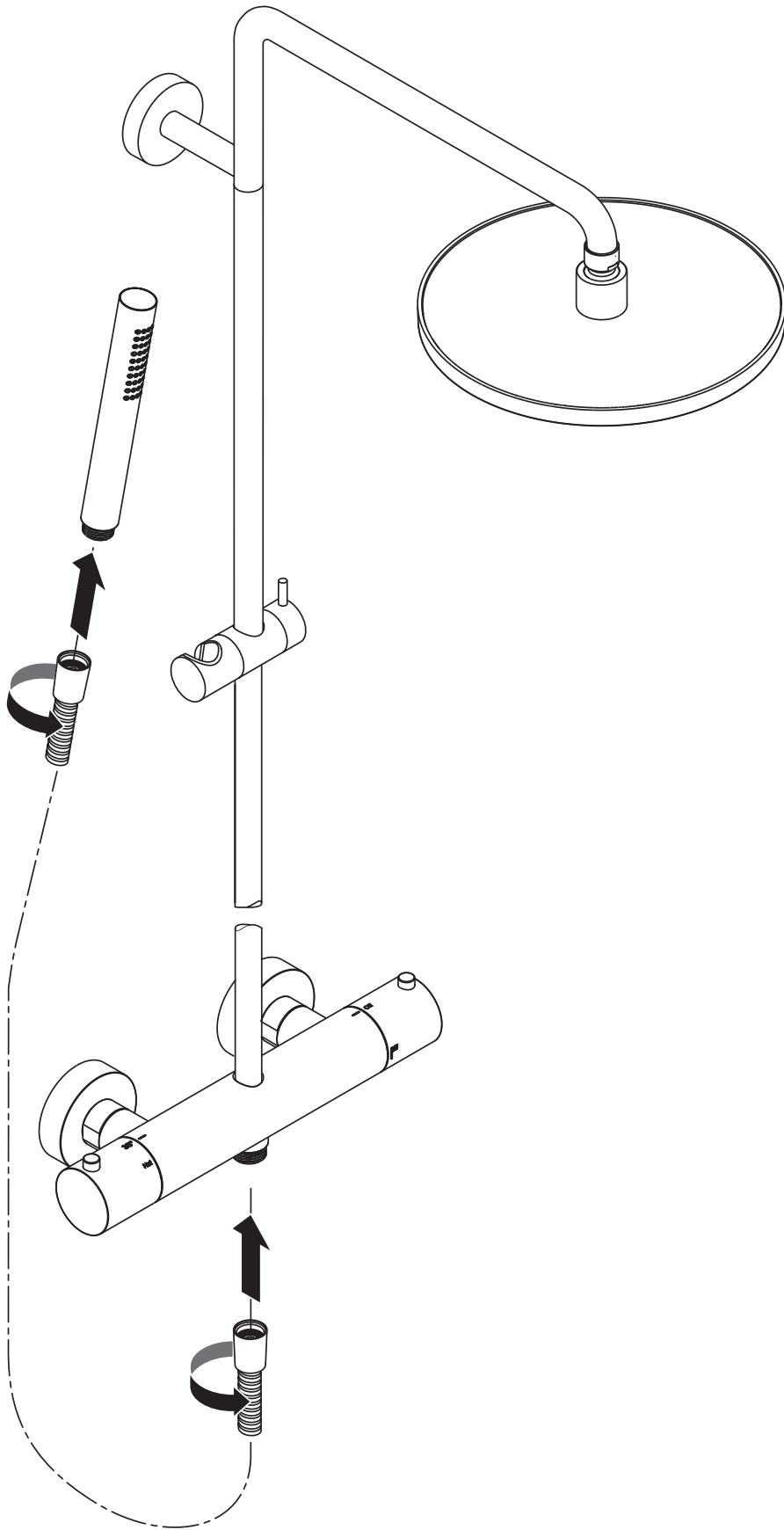

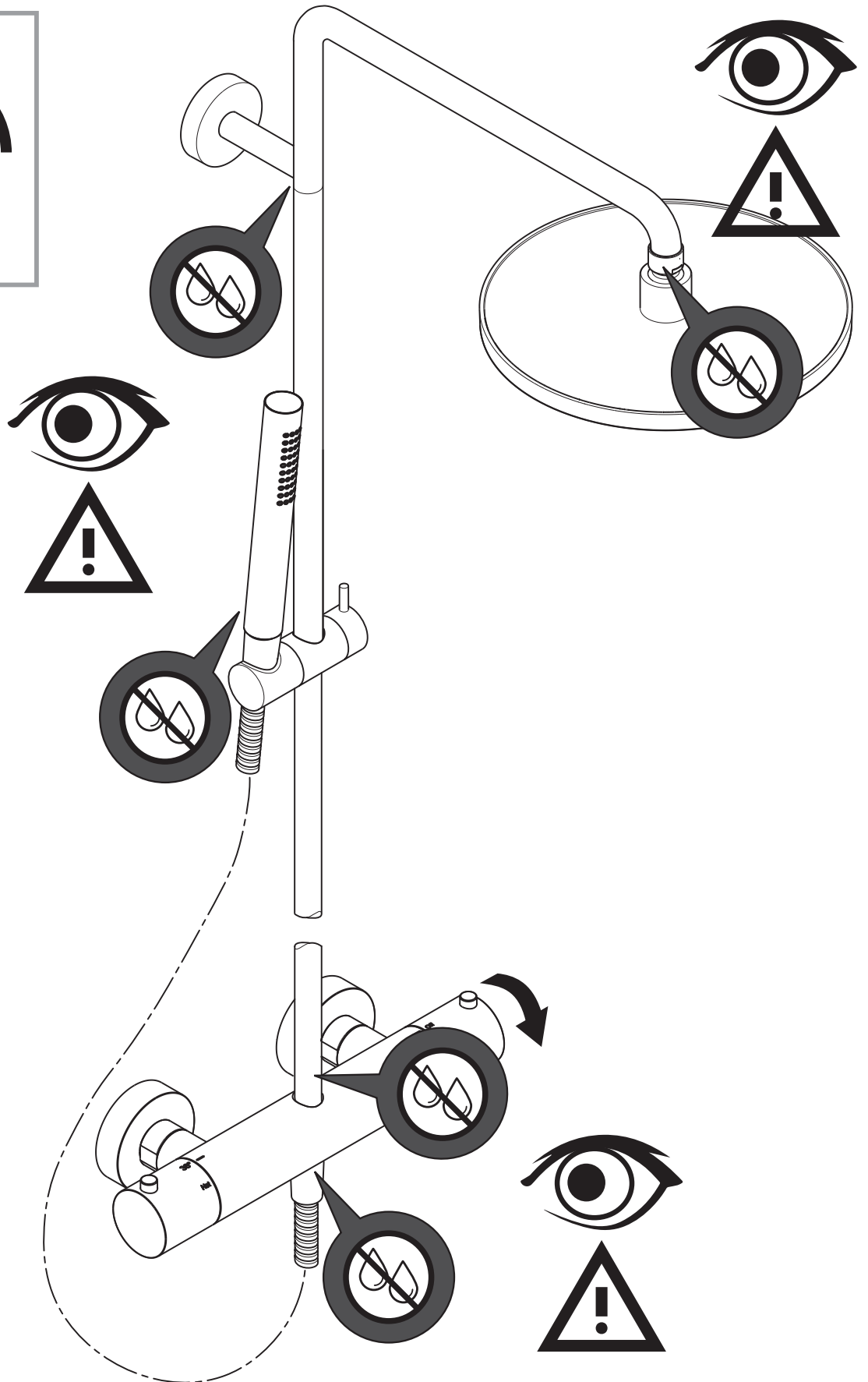
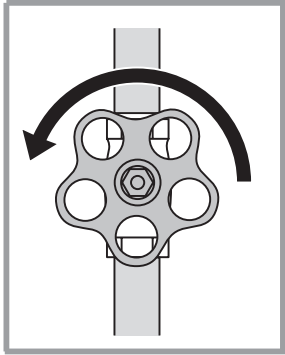

**FAR COINCIDERE
LA TACCA**
MATCH THE NOTCH

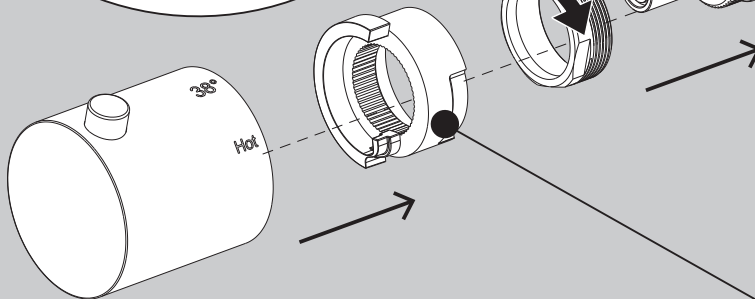
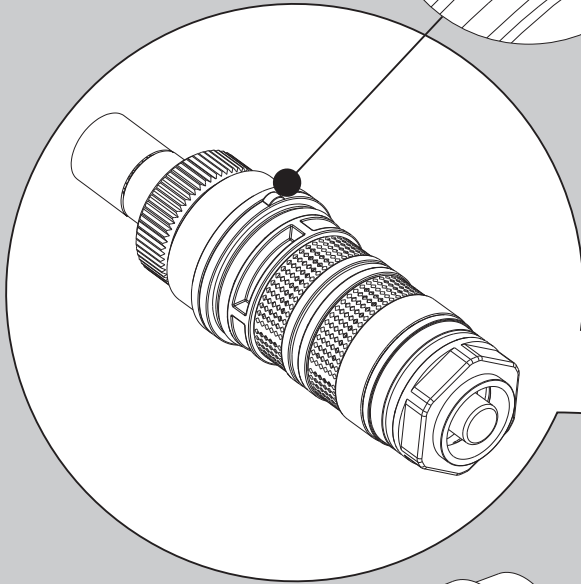
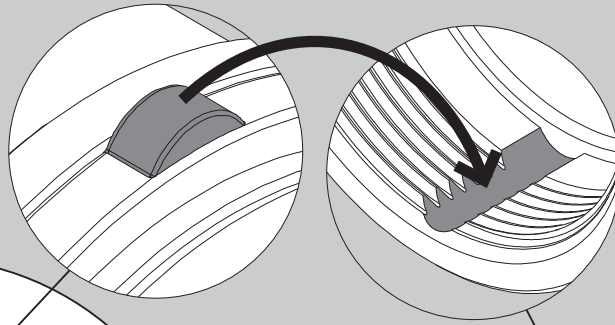

**ALLINEARE ALL'ASSE
VERTICALE**
ALIGN TO THE
VERTICAL AXIS

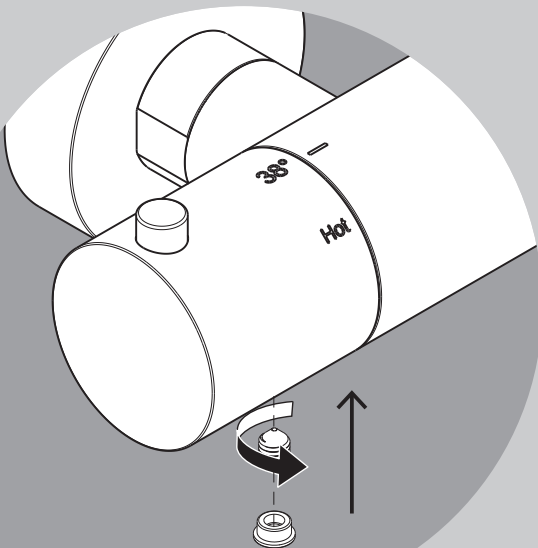
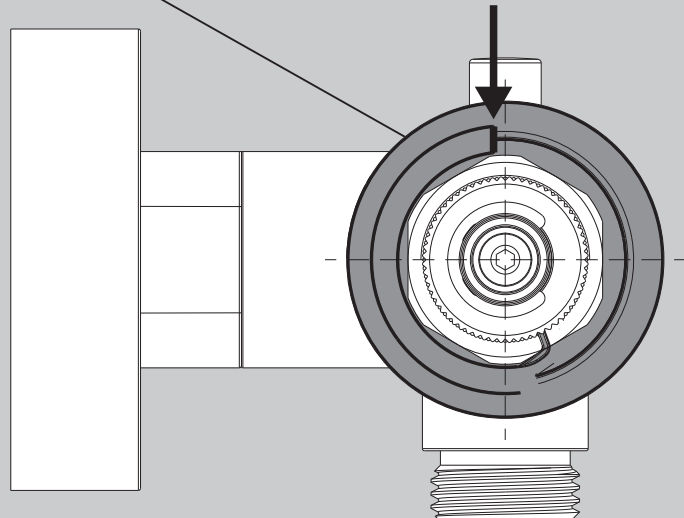

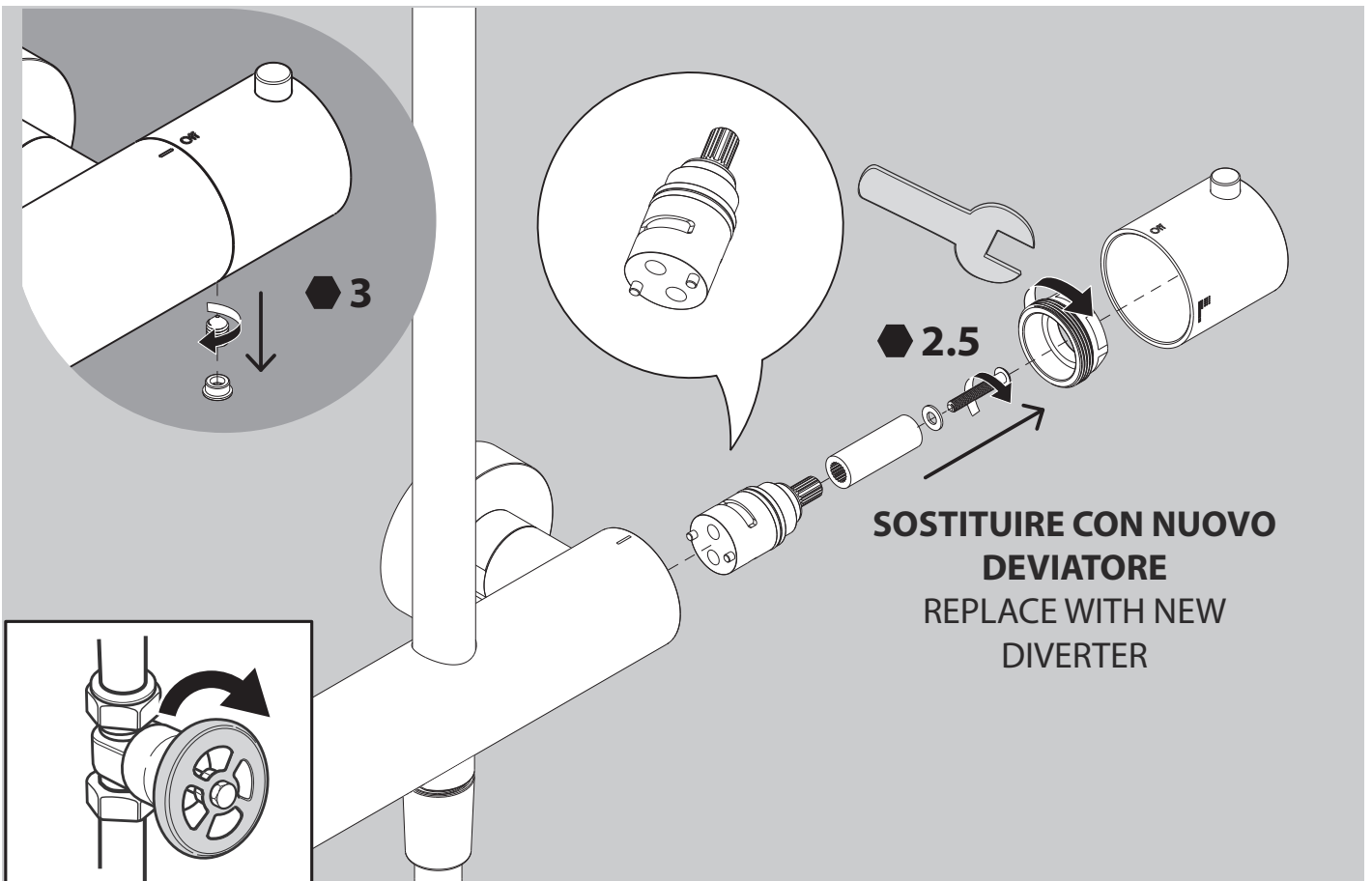
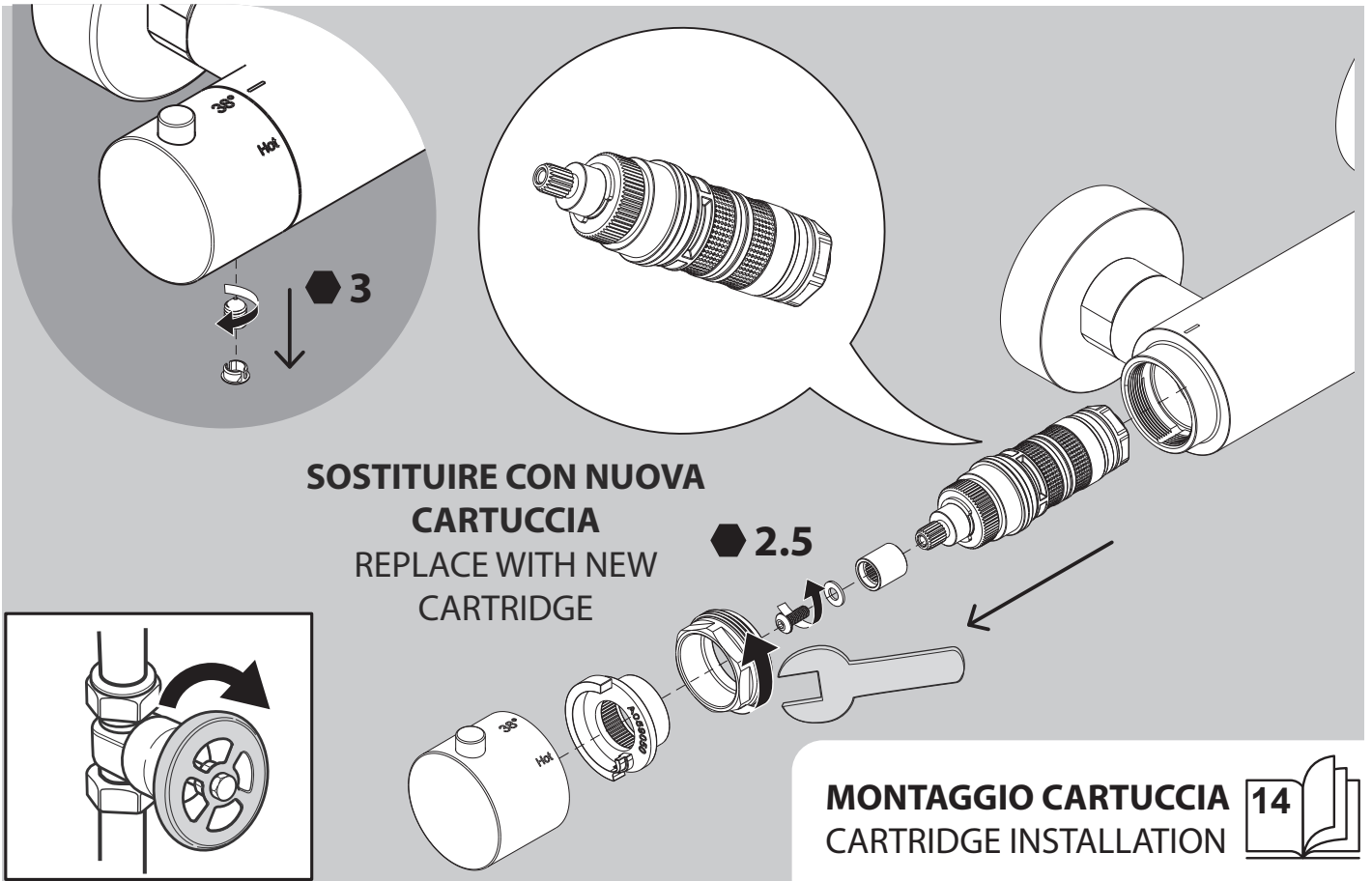

MANUTENZIONE E GARANZIA

MAINTENANCE AND WARRANTY

IT **IMPORTANTE: RICORDIAMO CHE LA GARANZIA NON COPRE I DANNI CAUSATI DAL DEPOSITO DI CALCARE O IMPURITA' O SE L'APPARECCHIO RISULTERA' AVER SUBITO TRATTAMENTI DIVERSI DA QUELLI DA NOI SUGGERITI.**

Per evitare danni al vostro bagno o all'apparecchiatura acquistata vi invitiamo ad osservare le seguenti raccomandazioni di utilizzo:

- Spurgare l'impianto prima di collegare l'apparecchio.
- Pulire periodicamente la fessura di erogazione acqua da eventuali depositi di calcare che potrebbero compromettere il corretto funzionamento.

Consiglio: L'installazione di un impianto di filtraggio e addolcitura delle acque migliora e prolunga la vita dei nostri apparecchi e dell'impianto stesso.

PULIZIA PARTI METALLICHE:

Per la semplice pulizia delle parti metalliche del prodotto è sufficiente usare un panno morbido e inumidito con acqua e sapone o un prodotto anticalcare.

Per evitare la formazione di macchie, dovute alla presenza di calcio nell'acqua, si consiglia di asciugare con un panno dopo ogni uso.

Consiglio: Si prega di usare solo detergenti naturali a base di sapone evitando quelli contenenti alcool, acido cloridrico o acido fosforico, candeggina, cloro, ecc., e quelli contenenti polveri abrasive.

L'apparecchio è garantito 2 anni contro difetti o vizi di fabbricazione: La garanzia non copre danni causati da:

- Installazione e/o utilizzo diversi da quelli suggeriti dal manuale d'uso e manutenzione.
- Errata predisposizione e realizzazione dell'impianto idrico.
- La normale e fisiologica usura per utilizzo corretto.
- Danni causati da deposito di calcare o impurità.
- Impiego di materiali di pulizia diversi da quelli qui indicati.

EN **IMPORTANT: PLEASE NOTE THAT THE WARRANTY DOES NOT COVER DAMAGES CAUSED BY LIME DEPOSITS OR IMPURITIES, OR IF THE APPLIANCE HAS BEEN SUBJECTED TO TREATMENTS OTHER THAN THOSE SUGGESTED BY US.**

To avoid damage to your bathroom or the purchased appliance, we recommend following these usage instructions:

- Flush the system before connecting the appliance.
- Periodically clean the water dispensing gap from any lime deposits that could impair its proper functioning.

Tip: Installing a water filtration and softening system improves and extends the life of our appliances and the system itself.

CLEANING METAL PARTS:

For simple cleaning of the metal parts of the product, use a soft cloth dampened with water and soap or a limescale remover.

To avoid the formation of stains caused by calcium in the water, it is recommended to dry with a cloth after each use.

Tip: Please use only natural soap-based cleaners, avoiding those containing alcohol, hydrochloric acid, phosphoric acid, bleach, chlorine, etc., and those with abrasive powders.

The appliance is guaranteed for 2 years against defects or manufacturing flaws:

The warranty does not cover damages caused by:

- Installation and/or use other than those suggested in the user and maintenance manual.
- Incorrect design and installation of the water system.
- Normal wear and tear from correct usage.
- Damage caused by lime deposits or impurities.
- Use of cleaning materials other than those specified here.

FR **IMPORTANT : NOUS RAPPELONS QUE LA GARANTIE NE COUVRE PAS LES DOMMAGES CAUSÉS PAR LE DÉPÔT DE CALCAIRE OU D'IMPURITÉS, NI SI L'APPAREIL A ÉTÉ SOUMIS À DES TRAITEMENTS AUTRES QUE CELLES SUGGÉRÉES PAR NOS SOINS.**

Pour éviter des dommages à votre salle de bain ou à l'appareil acheté, nous vous invitons à suivre les recommandations d'utilisation suivantes :

- Purger l'installation avant de connecter l'appareil.
- Nettoyer périodiquement la fente de distribution d'eau pour éliminer les dépôts de calcaire qui pourraient nuire à son bon fonctionnement.

Conseil : L'installation d'un système de filtration et d'adoucissement de l'eau améliore et prolonge la durée de vie de nos appareils et de l'installation elle-même.

NETTOYAGE DES PARTIES MÉTALLIQUES :

Pour le nettoyage simple des parties métalliques du produit, il suffit d'utiliser un chiffon doux et humide avec de l'eau et du savon ou un produit anticalcaire.

Pour éviter la formation de taches dues à la présence de calcium dans l'eau, il est conseillé de sécher avec un chiffon après chaque utilisation.

Conseil : Veuillez utiliser uniquement des produits de nettoyage naturels à base de savon, en évitant ceux contenant de l'alcool, de l'acide chlorhydrique, de l'acide phosphorique, de l'eau de Javel, du chlore, etc., ainsi que ceux contenant des poudres abrasives.

L'appareil est garanti 2 ans contre les défauts ou vices de fabrication:

La garantie ne couvre pas les dommages causés par :

- Installation et/ou utilisation non conformes à celles suggérées dans le manuel d'utilisation et d'entretien.
- Mauvaise préparation et réalisation de l'installation hydraulique.
- L'usure normale et physiologique due à une utilisation correcte.
- Dommages causés par des dépôts de calcaire ou d'impuretés.
- Utilisation de matériaux de nettoyage autres que ceux spécifiés ici.

ES **IMPORTANTE: RECORDAMOS QUE LA GARANTÍA NO CUBRE LOS DAÑOS CAUSADOS POR DEPOSITOS DE CAL Y OTRAS IMPUREZAS, NI SI EL APARATO HA SIDO SOMETIDO A TRATAMIENTOS DIFERENTES A LOS SUGERIDOS POR NOSOTROS.**

Para evitar daños en su baño o en el aparato adquirido, le recomendamos seguir las siguientes recomendaciones de uso:

- Purgar el sistema antes de conectar el aparato.
- Limpiar periódicamente la ranura de distribución de agua de posibles depósitos de cal que puedan afectar al correcto funcionamiento.

Consejo: La instalación de un sistema de filtrado y descalcificación de agua mejora y prolonga la vida útil de nuestros aparatos y del sistema en sí.

LIMPIEZA DE PARTES METÁLICAS:

Para la limpieza sencilla de las partes metálicas del producto, basta con usar un paño suave humedecido con agua y jabón o un producto antical.

Para evitar la formación de manchas causadas por el calcio en el agua, se recomienda secar con un paño después de cada uso.

Consejo: Utilice solo detergentes naturales a base de jabón, evitando aquellos que contengan alcohol, ácido clorhídrico, ácido fosfórico, lejía, cloro, etc., y los que contengan polvos abrasivos. El aparato está garantizado durante 2 años contra defectos de fabricación:

La garantía no cubre daños causados por:

- Instalación y/o uso no conforme a lo sugerido en el manual de

usuario y mantenimiento.

- Incorrecta predisposición y realización de la instalación hidráulica.
- El desgaste normal y fisiológico por uso correcto.
- Daños causados por depósitos de cal o impurezas.
- Uso de materiales de limpieza diferentes a los indicados aquí.

DE WICHTIG: WIR ERINNERN DARAN, DASS DIE GARANTIE KEINE SCHÄDEN ABDECKT, DIE DURCH KALKABLAGERUNGEN ODER IMPURITÄTEN VERURSACHT WERDEN, ODER WENN DAS GERÄT BEHANDLUNGEN AUSGESETZT WURDE, DIE NICHT VON UNS EMPFOHLEN WURDEN.

Um Schäden an Ihrem Badezimmer oder dem gekauften Gerät zu vermeiden, empfehlen wir, die folgenden Nutzungshinweise zu beachten:

- Spülen Sie das System, bevor Sie das Gerät anschließen.
- Reinigen Sie regelmäßig den Wasserauslassspalt von Kalkablagerungen, die die ordnungsgemäße Funktion beeinträchtigen könnten.

Tipp: Die Installation eines Wasserfiltersystems und einer Wasserenthärtungsanlage verbessert und verlängert die Lebensdauer unserer Geräte und des Systems selbst.

REINIGUNG VON METALLTEILEN:

Für die einfache Reinigung der Metallteile des Produkts genügt es, ein weiches Tuch zu verwenden, das mit Wasser und Seife oder einem Antikalkmittel befeuchtet ist.

Um die Bildung von Flecken durch Kalzium im Wasser zu vermeiden, wird empfohlen, das Gerät nach jedem Gebrauch mit einem Tuch abzutrocknen.

Tipp: Bitte verwenden Sie nur natürliche Reinigungsmittel auf Seifenbasis und vermeiden Sie solche, die Alkohol, Salzsäure, Phosphorsäure, Bleichmittel, Chlor usw. enthalten sowie abrasive Pulver.

Das Gerät ist 2 Jahre gegen Produktionsfehler und Materialfehler garantiert:

Die Garantie deckt keine Schäden ab, die durch folgende Ursachen verursacht werden:

- Installation und/oder Nutzung, die nicht den Anweisungen im Benutzerhandbuch und Wartungsplan entsprechen.
- Falsche Auslegung und Installation des Wassersystems.
- Normale Abnutzung durch korrekte Nutzung.
- Schäden durch Kalkablagerungen oder Verunreinigungen.
- Verwendung von Reinigungsmaterialien, die nicht hier angegeben sind.

